

JUDETUL PRAHOVA
 U.A.T.: AZUGA
 STRADA VALEA AZUGHI, SORICA
 TARLA 6 - PARCELA F78,F80,F81,CC82,CC83,F84,CC87,
 TARLA 24 - PARCELA F252,F253,PD249,DC471,DC472

SUPRAFATA TEREN ZONA STUDIATA: 156 252mp
 Numere cadastrale: 21686,20423,21180,22855,22449,20343,22557,22255,22261,
 22259,22304,20629,20936,20630,20931,20522,22305,20927,22607,22307,21264,
 20473,21661,21660,20320,21478,343,966,21232,21479,20980,20419,20337,20338,
 21464,21465,22568,367,344,20620,20195,22282,21999,22249,22450,21693,20209,
 22375,22390,22452,22451,20297,21310,22391,22444,22479,22480,22481,22260.

SUPORT TOPOGRAFIC

SCARA 1:1000

LEGENDA

- - stalp metal
- - stalp beton
- - punct stație
- - capot GPS
- - capot camin canalizare
- - capot camin apa
- — — conducta gaz
- — — curbe de nivel
- — — gard de lemn
- — — gard de plasa
- — — gard sarma ghimpată
- — — gard de metal
- — — zona studiata prin PUZ
- — — limita intravilan

Schema de dispunere a planselor

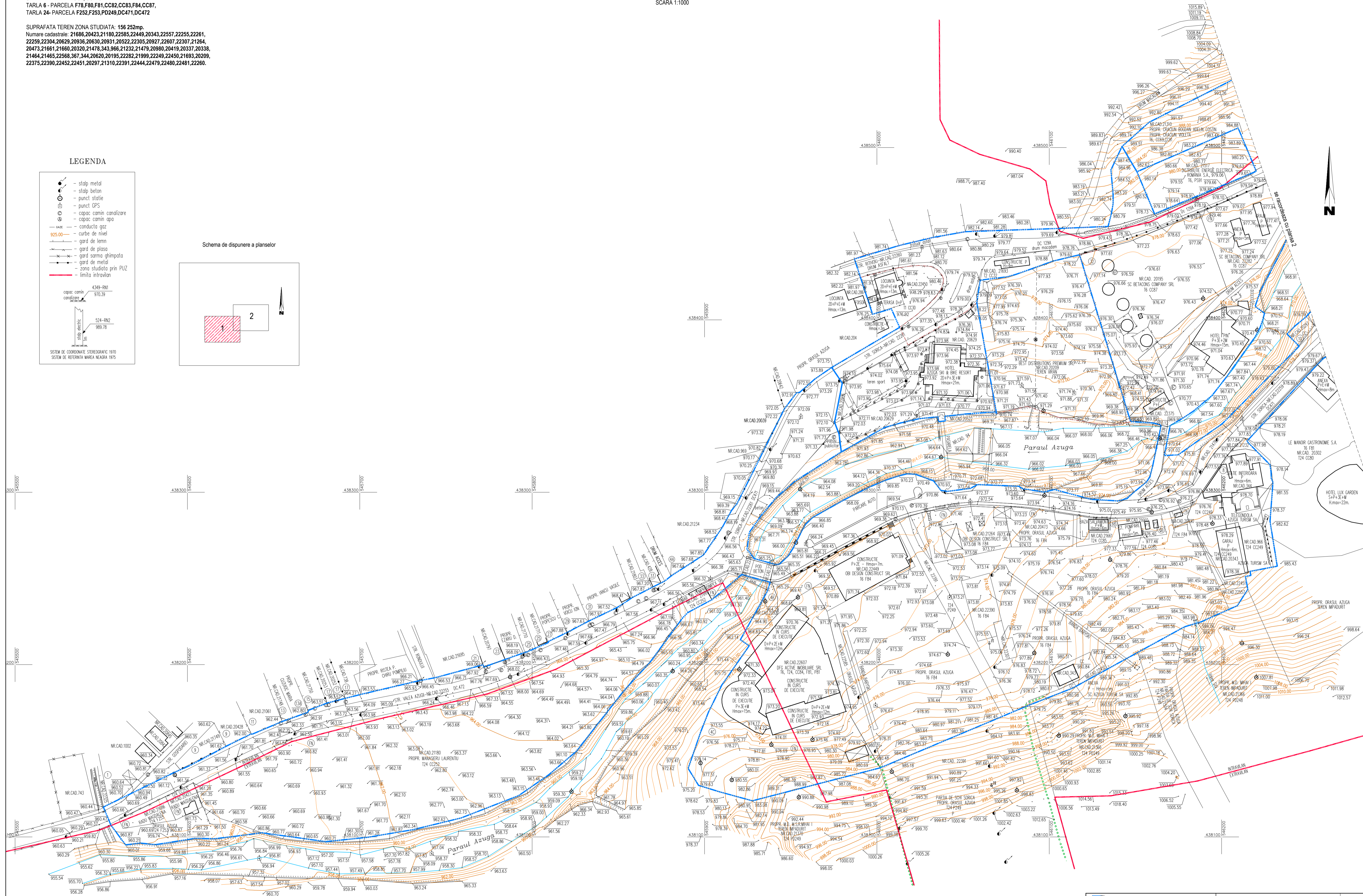
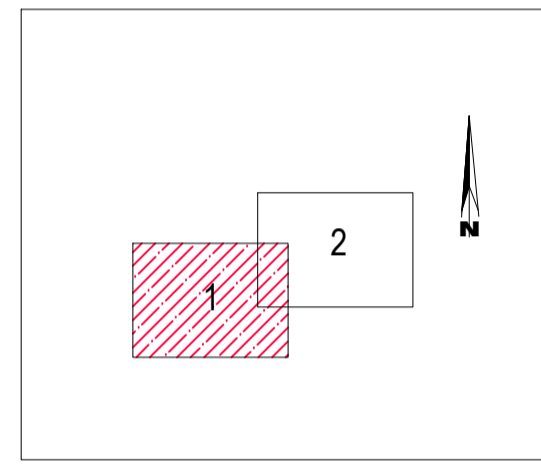

| | | | |
|---|---|-------------------------------|-----------------------------|
| <p>SC TOPOMONT CONSULT SRL CUI: RO605296, 2015002004 AUT. nr. RO-BA-1 nr. 0917 din 28.07.2016</p> | OBIECTUL LUCRARIILOR: SUPORT TOPOGRAFIC PENTRU PUZ | | plansa 1/2 |
| | PERSONA AUTORIZATA A.N.C.P.I. AUT. nr. RO-B-F-rr. 0403 din 02.11.2010 CATEGORIA A ing. Mircea-Damian Nicolae-Adrian | scara 1:1000 data: 05.2024 | BENEFICIAR: ORASUL AZUGA |